

PLAIN MODEL SLIDES

ALM

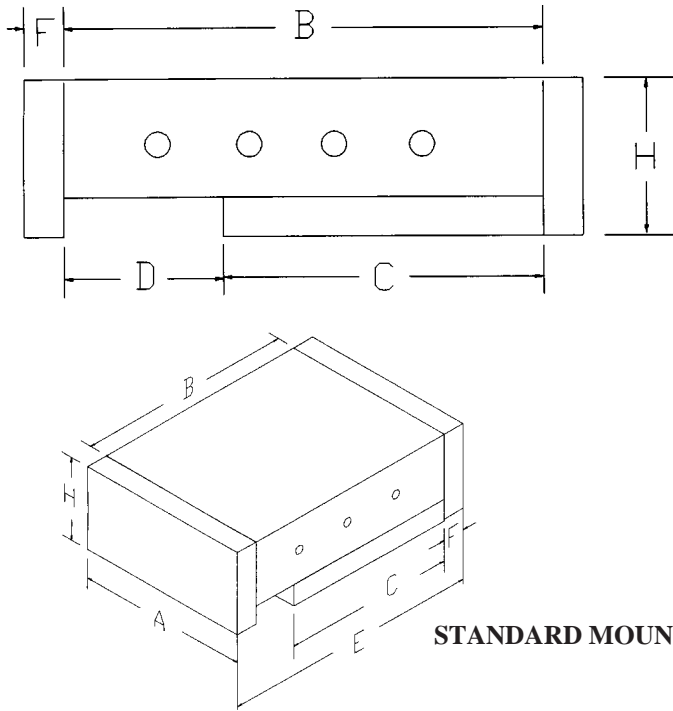

STANDARD MOUNTING HOLES AVAILABLE

PLEASE DESIGNATE MATERIAL
 A = ALUMINUM
 C = CAST IRON

Detail Dimensions Pg. 42 & 43

MODEL #	A	B	C	D	E	F	H	RAIL SET	WEIGHT (LBS)		MAX CC (LBS)
	WIDTH	APL	FPL	TRAVEL	OAL	EP	HEIGHT		A	C	
P(A/C)2-3-1	2.0 50.8	3.0 76.2	2.0 50.8	1.0 25.4	3.5 88.9	0.25 6.4	0.98 25.0	RS118-02-07-C	0.7	1.4	174
P(A/C)2-4-1	2.0 50.8	4.0 101.6	3.0 76.2	1.0 25.4	4.5 114.3	0.25 6.4	0.98 25.0	RS118-03-12-C	0.9	1.9	348
P(A/C)2-6-2	2.0 50.8	6.0 152.4	4.0 101.6	2.0 50.8	6.5 165.1	0.25 6.4	0.98 25.0	RS118-04-15-C	1.2	2.7	406
P(A/C)3-4-1	3.0 76.2	4.0 101.6	3.0 76.2	1.0 25.4	4.5 114.3	0.25 6.4	1.25 31.7	RS118-03-12-C	1.5	3.7	348
P(A/C)3-5-1	3.0 76.2	5.0 127.0	4.0 101.6	1.0 25.4	5.5 139.7	0.25 6.4	1.25 31.7	RS118-04-17-C	1.9	4.4	464
P(A/C)3-6-2	3.0 76.2	6.0 152.4	4.0 101.6	2.0 50.8	6.5 165.1	0.25 6.4	1.25 31.7	RS118-04-15-C	2.1	4.9	406
P(A/C)4-6-1	4.0 101.6	6.0 152.4	5.0 127.0	1.0 25.4	6.5 165.1	0.25 6.4	1.44 36.5	RS118-05-22-C	3.4	8.2	638
P(A/C)4-8-2	4.0 101.6	8.0 203.2	6.0 152.4	2.0 50.8	8.5 215.9	0.25 6.4	1.44 36.5	RS118-06-25-C	4.1	10.5	696
P(A/C)4-10-2	4.0 101.6	10.0 254.0	8.0 203.2	2.0 50.8	10.5 266.7	0.25 6.4	1.44 36.5	RS118-08-35-C	5.3	13.0	986
P(A/C)4-12-3	4.0 101.6	12.0 304.8	9.0 228.6	3.0 76.2	12.5 317.5	0.25 6.4	1.44 36.5	RS118-09-37-C	6.0	15.0	1044
P(A/C)6-8-2	6.0 152.4	8.0 203.2	6.0 152.4	2.0 50.8	8.5 215.9	0.25 6.4	2.0 50.8	RS236-06-10-C	8.9	22.0	1200
P(A/C)6-12-4	6.0 152.4	12.0 304.8	8.0 203.2	4.0 101.6	12.5 317.5	0.25 6.4	2.0 50.8	RS236-08-12-C	12.1	29.0	1440
P(A/C)6-16-6	6.0 152.4	16.0 406.4	10.0 254.0	6.0 152.4	16.5 419.1	0.25 6.4	2.0 50.8	RS236-10-14-C	15.3	40.5	1680